



Instructions

JEEP JL/JT OVERHEAD MOLLE SHELF

Thank you for purchasing the JL/JT Overhead MOLLE Shelf from AAL! We greatly appreciate your trust in our company. We take that purchase and your commitment to us very seriously. If you have any questions along the way, please don't hesitate to give us a call at 385.202.4188.

If you would like to familiarize yourself with the install process, we have a detailed video available at <http://aal.cx/oms-video>.

Please read these instructions thoroughly before starting this project.

Tools Required:

There is more than one tool for every job, but below is the list of tools we use for this installation.

- Ratchet
- T25 Torx Socket
- T40 Torx Socket
- 5MM Allen Socket
- 4MM Allen Socket
- 10MM Wrench
- 13MM Wrench
- Flathead Screwdriver

Identify and Verify Hardware Included:

Inside your box, you should have the following hardware:

- (4) 6mm x 20mm Button Head Flange Bolts
- (14) 6mm x 14mm Button Head Bolts
- (18) 6mm Lock Nuts
- (4) 8mm x 60mm Flat Socket Head Bolts
- (4) 8mm Lock Nuts
- (8) 8mm Washers



Step 1 - Connect Main MOLLE Panels

In this step, you will need the two matching MOLLE panels, the larger of the two flat steel braces, and the small connecting brace. Arrange these components as shown below.

Lay the two large MOLLE panels onto a flat surface. There is a front and rear orientation to these panels. The larger of the two edge flanges will go toward the front of the Jeep.

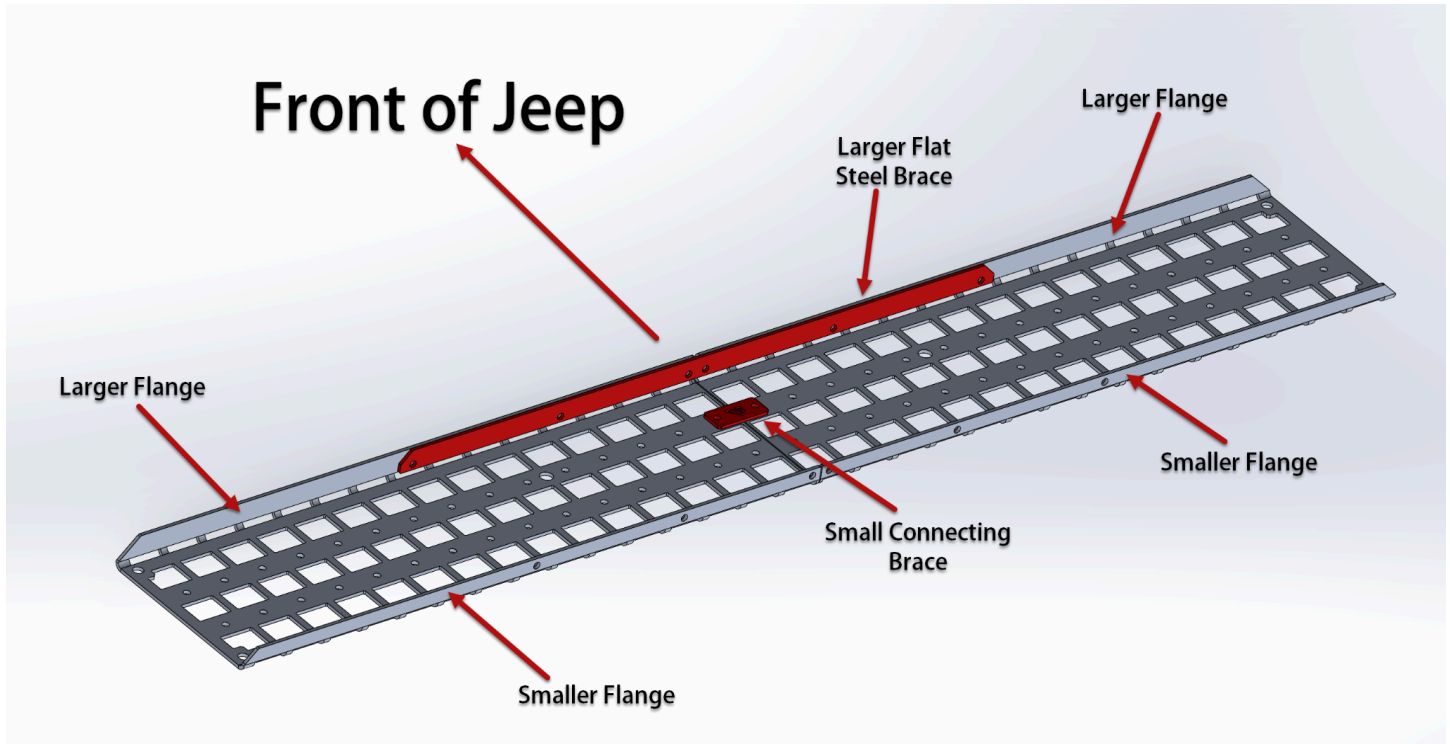

Assemble these components with (8) of the M6 x 14mm button head bolts, and (8) of the M6 lock nuts.

The bolts should be inserted from the outside in so that the nuts are not visible from the outside of the shelf. See the illustration at the top of the next page for reference.

NOTE: It helps to leave all of the fasteners loose until final tightening. There is a lot of variance, between vehicles, in the cage assembly. Leaving everything loose during install will ensure a better fit for your particular vehicle.

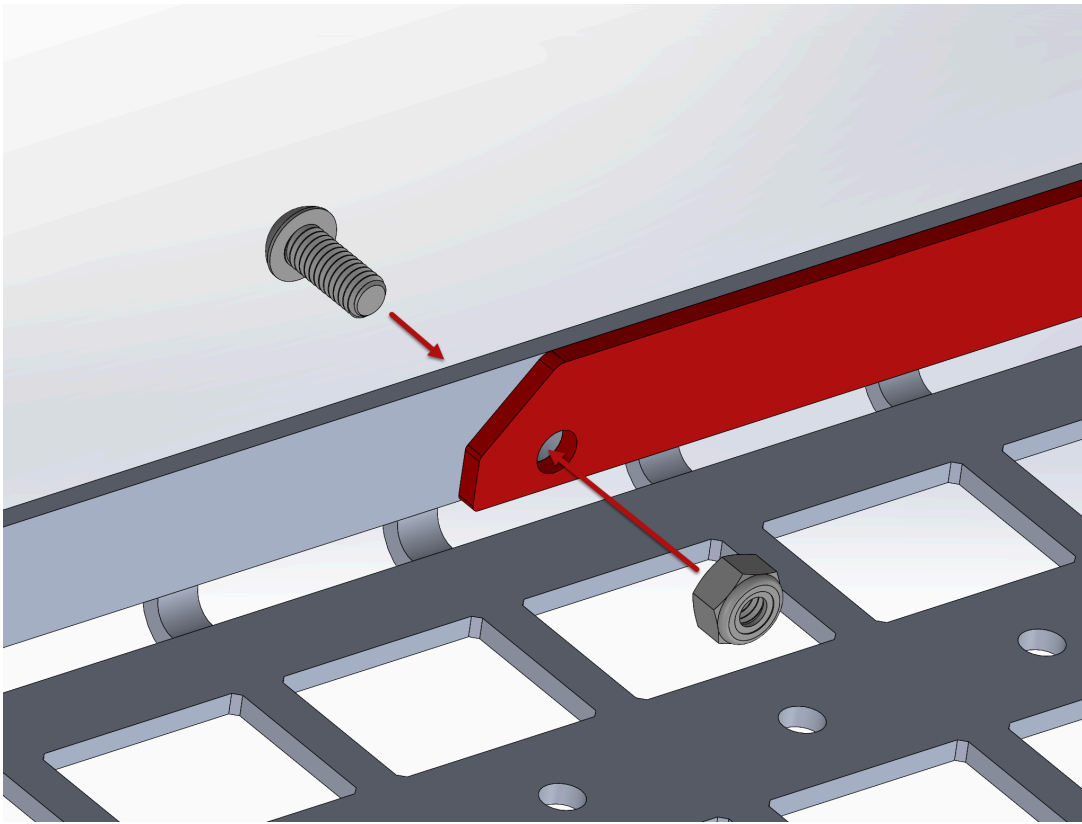

The small center connecting brace should be oriented as shown below. This position will ensure that the AAL logo is legible from the driving position below the shelf.

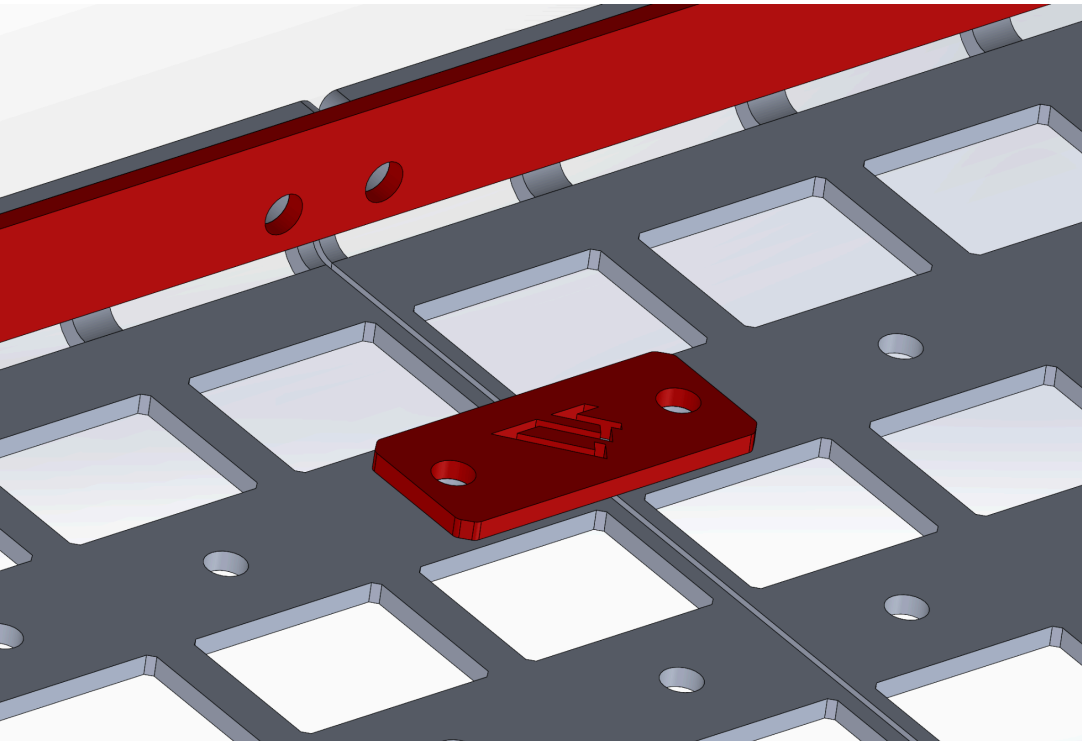

Step 2 - Attach Center MOLLE Panel

Locate the center MOLLE panel, and the remaining, thinner, steel shelf brace. Position this brace, as seen in the diagram below, and align the center MOLLE panel as shown.

Next, using (4) M6 x 20mm button head flange bolts, (2) M6 x 14mm button head bolts, and (6) M6 lock nuts, attach the center MOLLE panel to the previously assembled shelf halves. **Note:** The steel brace goes on the inside of the MOLLE shelf.

Once positioned, install the bolts in the proper location as shown in the image below. Make sure your bolts go through the steel brace as well.

Now that the center MOLLE panel is attached, you can tighten all of the currently installed bolts. This will stiffen the shelf assembly and make it easier to handle for the next install steps.

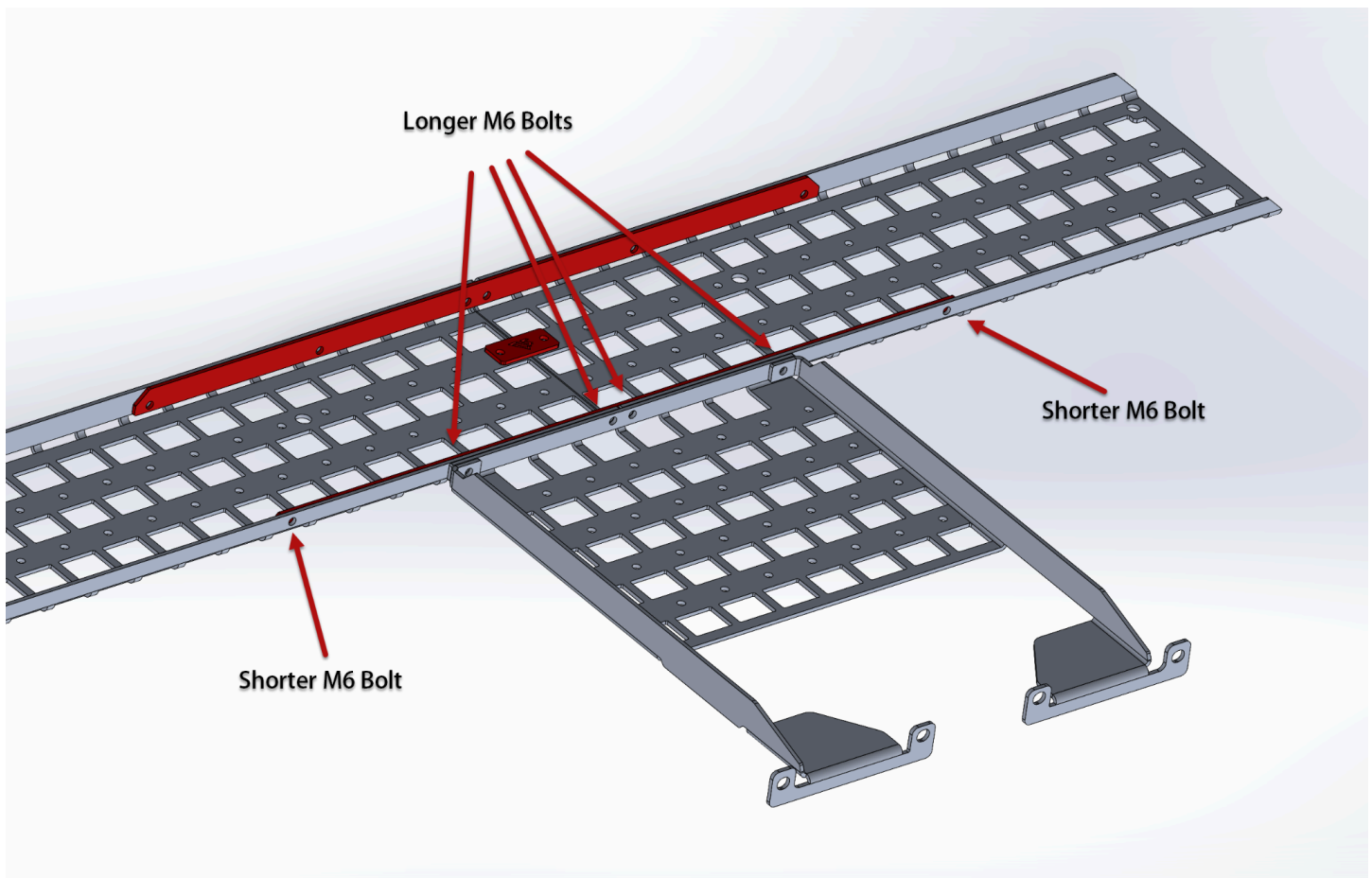

Step 3 - Install Roll Cage Brackets

Locate the two remaining pieces, which are the steel roll cage brackets. Both brackets are identical and can be used on either side. Just pay attention to the orientation as shown in the illustration below.

After you orient the mounting brackets correctly, they can be connected to the MOLLE shelf using the (4) remaining M6 x 14mm button head bolts and lock nuts. The bolts should go in from the bottom side of the bracket with the nuts on the top surface of the shelf. It is normal for there to be a lot of movement between these components, as this is where the majority of the variance in vehicles will be compensated for. Do not tighten these bolts at this time.

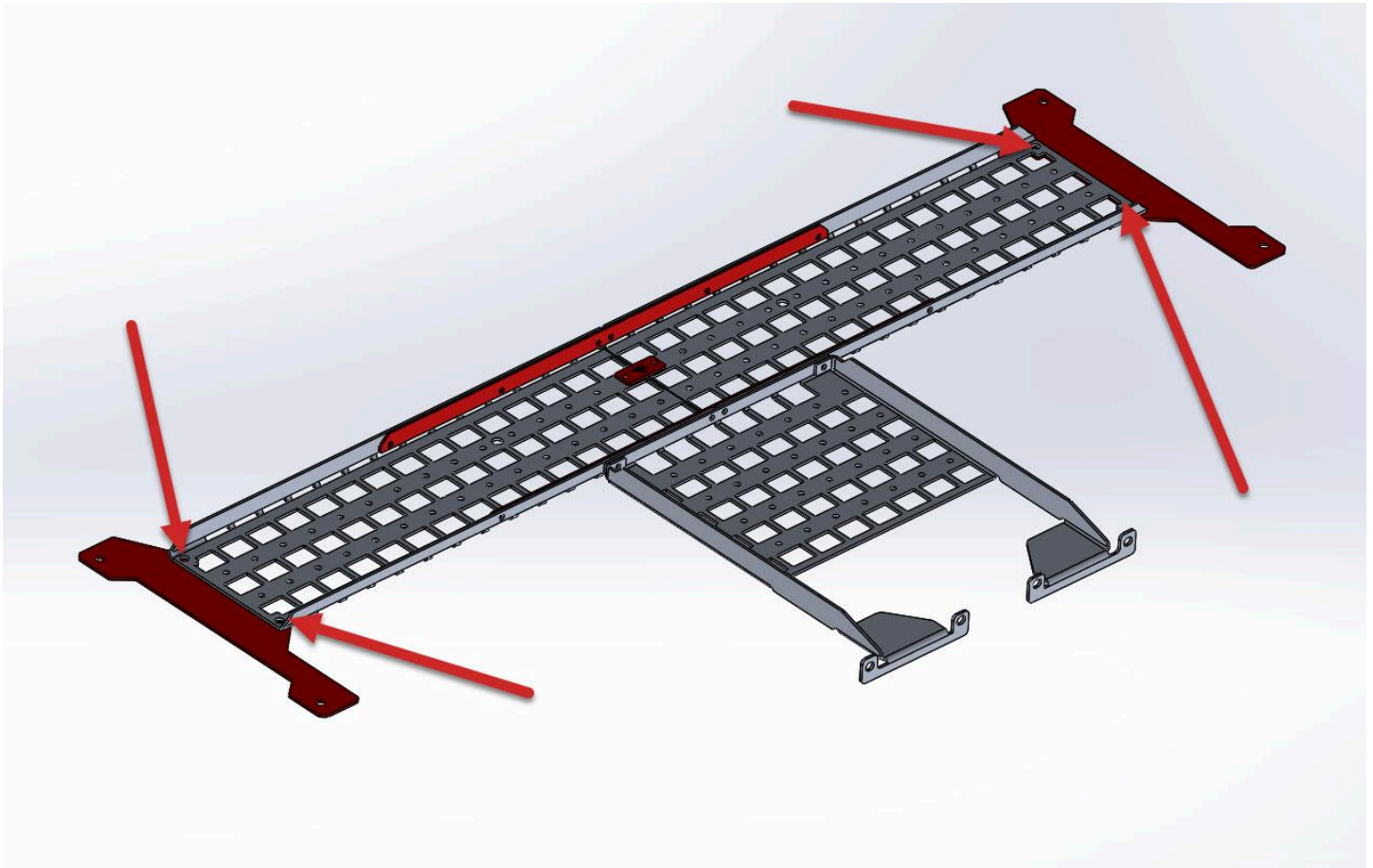

Step 4 - Freedom Top Latch Bracket Removal

Remove your left and right Freedom Panels.

The center MOLLE panel attaches under the rear, center Freedom Top latch brackets on the center section of the roll cage. In order to access the bolts that hold Freedom Top brackets, you will, first, need to loosen and pull down the plastic panel that also houses the dome lights.

Using a T25 Torx socket, remove the (3) panel retaining screws visible from the front side of the plastic roll cage cover. By pulling down on the front, center of the panel (**see photo below**), you can gain access to the retaining clips that are holding the panel to the roll cage. Using a flathead screwdriver, you can release the clips along the front side of the panel to allow the plastic to come down enough to access the Freedom Top bracket bolts. It is not necessary to fully remove the plastic cover.

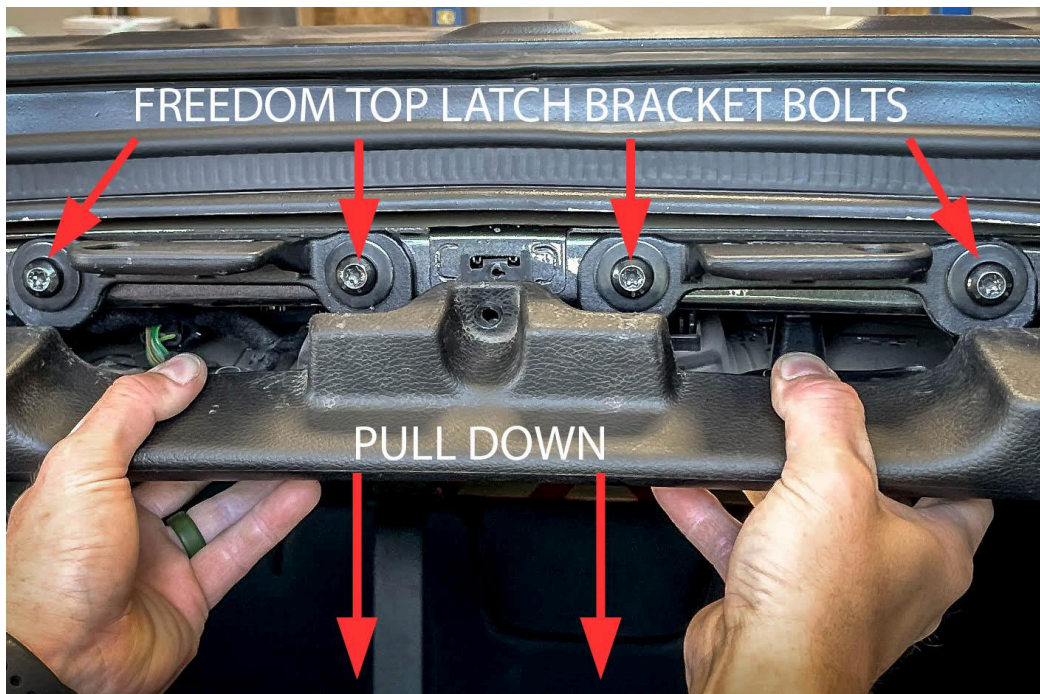

Using a T40 torx socket, remove the four bolts that attach the Freedom Top brackets to the roll cage. The brackets should be removed with the bolts. The bolts and brackets will be reused.

Step 5 - Position Shelf

You can now lay the assembled shelf on the top of the roll cage and align the holes in the roll cage with the holes in the outer (left to right) roll cage brackets. This will also position the rear four bolt holes.

Now that the shelf is positioned, you can install the outer roll cage bolts. These should be inserted into the shelf and cage as illustrated below. The bolts should go in from the bottom side of the roll cage and up through the top of the mounting brackets with a washer on each side (top and bottom). Once all four bolts (two on the driver's side and two on the passenger side) have been aligned and installed, you can move on to the next step. **Leave these bolts loose for now.**

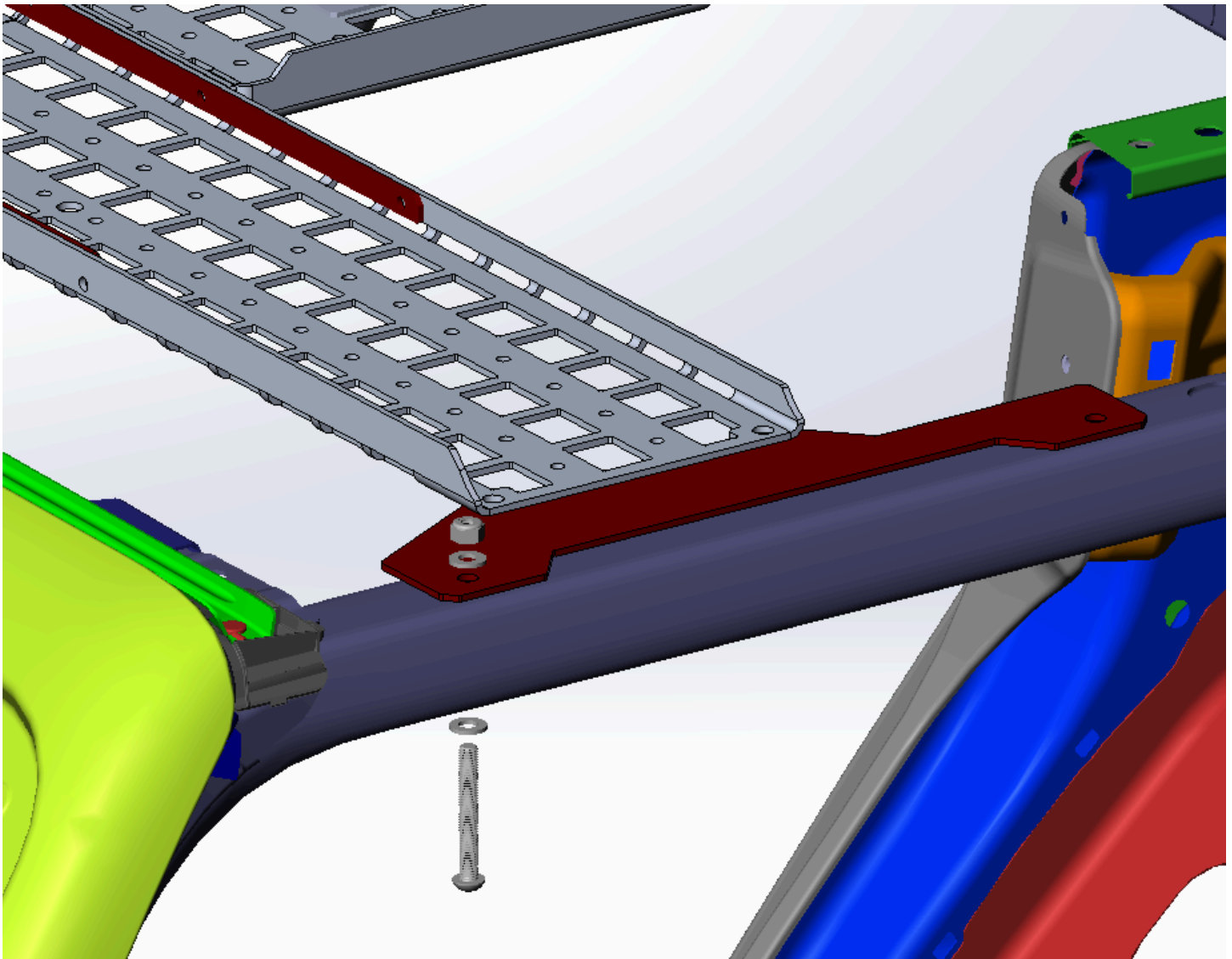

Step 6 - Reinstall Freedom Top Brackets

To make the final connection, position the Freedom Top brackets in between the MOLLE shelf and the roll cage. These brackets need to fit in their original location so the Freedom Tops can still function as designed. Align each of the Freedom Top Brackets with its original holes and reinstall with factory bolts.



Once all bolts are started, you can tighten them down using the T40 torx bit.

Note: Make sure to position the Freedom Top brackets level and with a decent gap between the brackets and the MOLLE shelf. This will ensure that the top latches have plenty of space to function properly.

You can now reinstall the plastic cover for the roll cage. This should be as simple as lining up the clips and gently bumping the cover back into position and reinstalling the (3) factory panel screws with a T25 torx bit.

Step 7 - Tighten Outer Roll Cage Brackets

Now that the shelf is fully positioned and the rear roll cage bolts have been tightened, you can tighten the remaining (8) roll cage attachment bolts. Using a 5mm allen socket and 13mm wrench, tighten the (4) main M8 bolts, securing the steel side brackets to the roll cage. Finally, you can tighten the (4) M6 bolts identified below with a 4mm allen socket and 10mm wrench. Once these are tight, your Overhead Molle Shelf is fully installed.



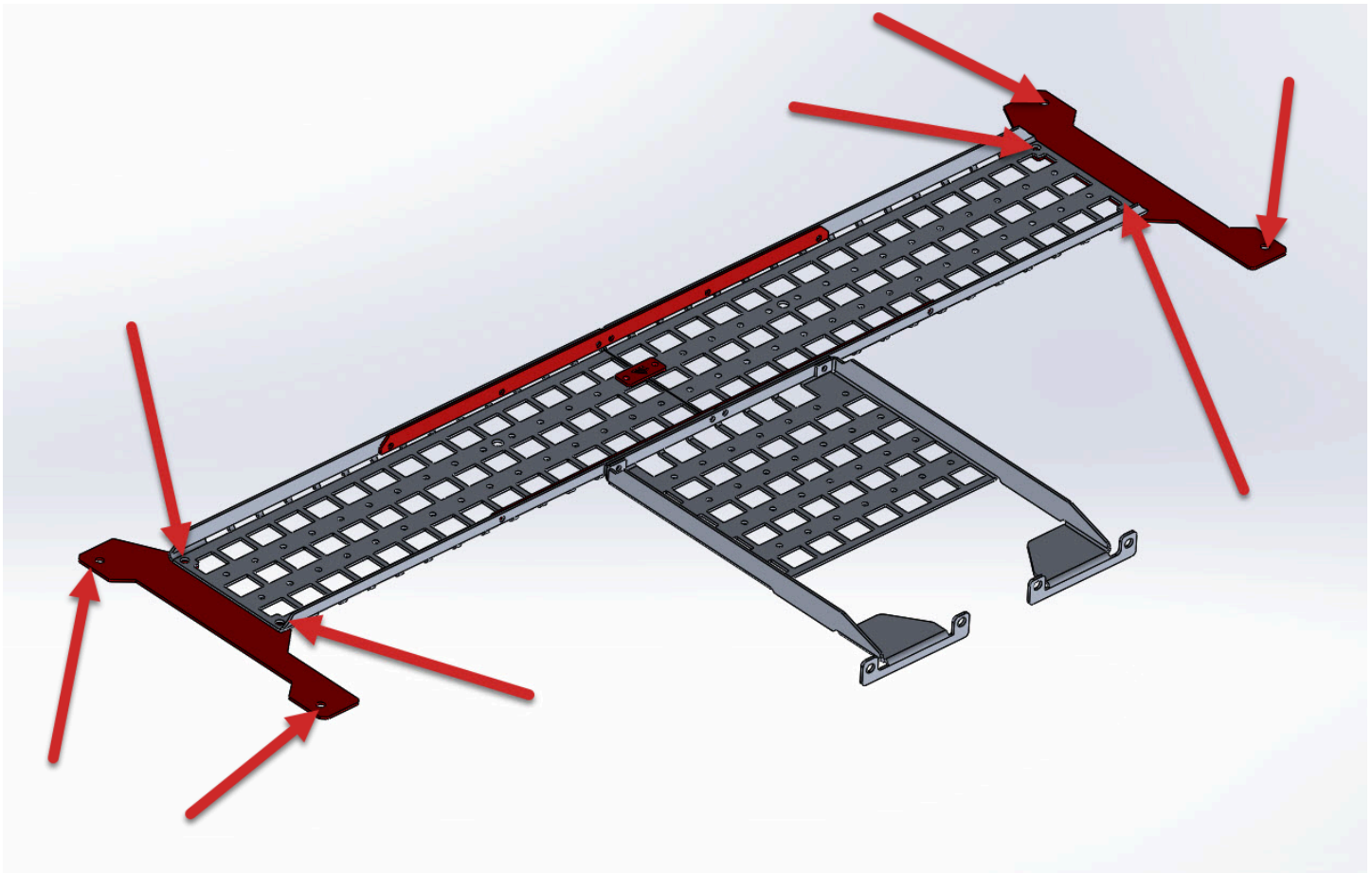

Sky One Touch Top Addendum

The sky one touch top version of the Overhead MOLLE Shelf is a bit different from our standard version. The mounting brackets for the roll bars are slightly different and will bolt from underneath the roll bar instead of above it using the OEM threaded holes. The two main molle panels are also slightly different, as their front flanges are bent downward.

Addition Hardware Included:

- (x4) Polymer Spacers
- (x4) M6 x 100 Button Head Bolts/Washers
- Edge molding

See images below for reference.

On each side you will reuse one of the longer factory bolts, one M6x100 bolt, and 2 Polymer Spacers between the roll bar and the bracket that we have supplied to mount the brackets to the roll bar!



Driver's Side



Passenger Side



Step 8: Share Your Photos

We take great pride in building our products and we hope that pride extends to you after installing your Overhead MOLLE Shelf. If you are able to share your photos online (Facebook and Instagram), please tag **@AmericanAdventureLab**. We would love to see how it turned out and give you some reciprocal attention in return!

Congrats! You're all done!

Thank you!

At American Adventure Lab, we strive to improve anywhere we can. If you experience any issues with this product or have any suggestions, please let us know.

If you have any questions or concerns, please don't hesitate to reach out to us at 385.202.4188 or via email at Sales@AmericanAdventureLab.com.

